

000000

000000

0000000000

00000000000000

000000000000

00000000

Product Features

- ö Intel® Apollo Lake N3350 1.1 GHz
- ö Fanless cooling system
- ö Compact size 100 x 70 x 31 mm (w/o mounting bracket)
- ö Expansion module design
- ö Various mounting options: desk, wall, VESA, DIN-Rail
- ö Suitable for smart factory applications



0000

ö Optional Storage

32GB mSATA

64GB mSATA

ö Optional Mounting

sD

/ErD

0000

EACWSLT-222 4G

EACWSLT-223 3G

000 000

000 000000

000 0000

EACWLST-234 2-port USB 2.0 x 3

000 000



Factory



Dachy e AutomaYov



DP] taoSurvebavce System



Ivteoo]vt TravnportaYov

000

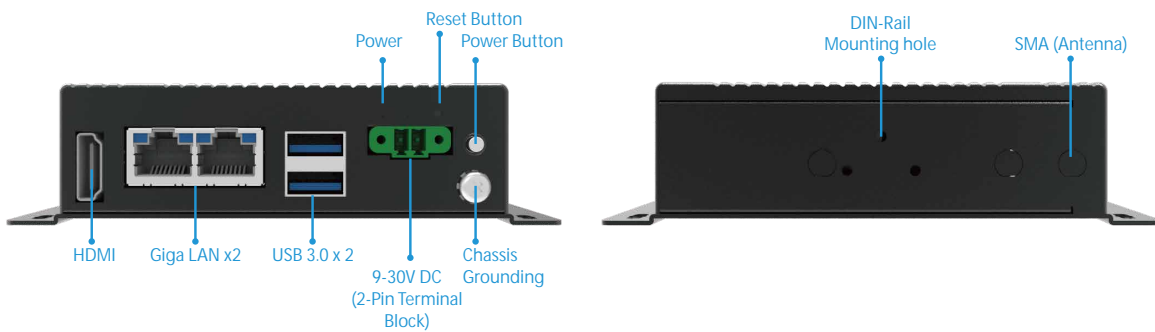

DZ00E

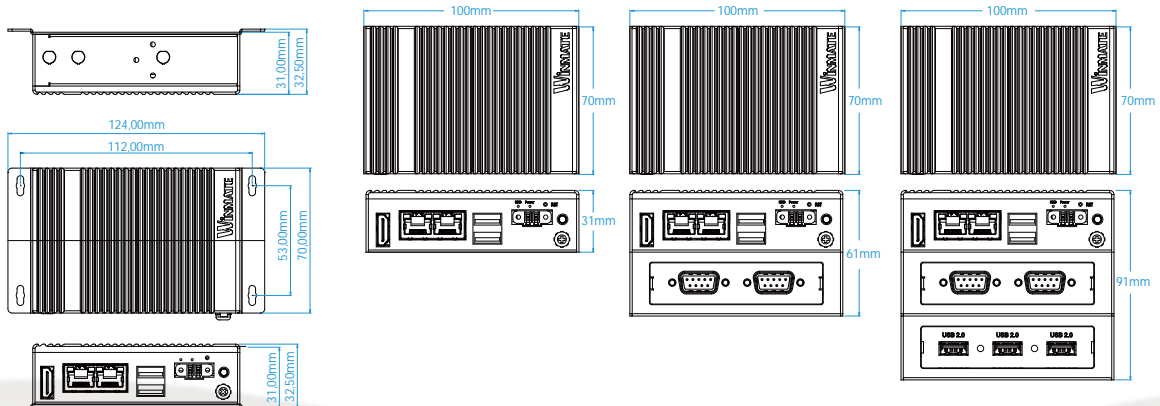

Product Specifications

System Specification		Certificate	
CPU	Intel® Apollo Lake N3350 1.1 GHz	EMC & Safety	CE, FCC
Graphics Engine	Intel® HD Graphics	Operating System (Optional)	
BIOS	Insyde UEFI	OS	Windows® 10 IoT Enterprise Linux Ubuntu
Watchdog Timer	Programmable 256 levels, timer interval 1 to 255 sec.	Ordering information	
Technology	4GB LPDDR3 1866MHz	EACIL20-100-A432	Intel N3350, 4G RAM, 32GB eMMC, 2 x USB 3.0, 2 x GbE LAN, 1 x HDMI
Storage		EACIL20-100-A432W10	Intel N3350, 4G RAM, 32GB eMMC, 2 x USB 3.0, 2 x GbE LAN, 1 x HDMI, Windows 10
eMMC	Onboard 32 GB (default), up to 128GB	EACIL20-101-A432	Intel N3350, 4G RAM, 32GB eMMC, 2 x USB 3.0, 2 x GbE LAN, 1 x HDMI, Wi-Fi(Client)
mSATA	up to 1TGB (Option)	EACIL20-102-A432	Intel N3350, 4G RAM, 32GB eMMC, 2 x USB 3.0, 2 x GbE LAN, 1 x HDMI, 4G
Expansion		EACIL20-103-A432	Intel N3350, 4G RAM, 32GB eMMC, 2 x USB 3.0, 2 x GbE LAN, 1 x HDMI, 3G
mPCIe	1 x Full-size mPCIe slot	EACIL20-104-A432	Intel N3350, 4G RAM, 32GB eMMC, 2 x USB 3.0, 2 x GbE LAN, 1 x HDMI, Access Point
USB Wafer	2 x USB Wafer	EACIL20-100-A464	Intel N3350, 4G RAM, 64GB eMMC, 2 x USB 3.0, 2 x GbE LAN, 1 x HDMI,
External I/O		EACIL20-100-A464W10	Intel N3350, 4G RAM, 64GB eMMC, 2 x USB 3.0, 2 x GbE LAN, 1 x HDMI, Windows 10
USB	2 x USB3.0	EACIL20-119-A432	Intel N3350, 4G RAM, 32GB eMMC, 2 x USB 3.0, 2 x GbE LAN, 1 x HDMI, mSATA expansion
Ethernet	2 x Giga LAN RJ45 Connector	Expansion Module (Optional)	
HDMI	1 x HDMI, supports 1920 x 1080@60 Hz	EACWSLT-222	4G
Buttons and LED Indicators		EACWSLT-223	3G
LED Indicator	1 x Power	EACWSLT-231	3-port RS232/422/485 w/ isolation
Button	1 x Power Button 1 x Reset Button	EACWSLT-232	24-Channel Digital I/O w/ isolation
Power Management		EACWSLT-233	2-port CANBUS w/ isolation
Power Supply	9V to 36V DC, 2-Pin Terminal Block	EACWLST-234	2-port USB 2.0 x 3
Grounding Protection	Chassis Grounding	EACWLST-235	2-port RS232/422/485 w/ isolation
Mechanical Specification		Accessories	
Dimensions	100 (W) x 70 (H) x 31(D) mm(One layer) 100 (W) x 70 (H) x 61(D) mm(Double layer)	Standard	<ul style="list-style-type: none"> Quick Start Guide (P/N #915211101025) Driver CD(P/N #917111101000) Terminal Block 2 pin to 2.5Ø Female Adapter Cable (P/N #94J602G020K2)
Weight	0.6 kg (One layer), 0.7 kg (double layer)	Optional	<ul style="list-style-type: none"> WLAN External Antenna (P/N #397SM0000002) WWAN External Antenna (P/N #39700000000H) AC Adapter 12V/36W (P/N #922D036W12V6) VESA Mounting Kit (P/N #98K000A0009A) DIN Rail Mounting Kit (P/N #98K000A00099)
Mounting	Desk Mounting (Default), Wall Mounting (Default), VESA Mounting (Optional), DIN-Rail Mounting (Optional),		
Cooling System	Fanless		
Enclosure	Metal Housing		
Environment			
Operating Temp.	-15~55° C		
Storage Temp.	-15~70° C		
Operating Humidity	10~90% RH		
Shock	Operating, IEC 60068-2-27		
Vibration	Operating, IEC 60068-2-64		
IP Rating	IP30		