

# 10.1" S-Series HMI - W10IB3S-PCH2AC-PoE

## Mechanical Design

- 10.1" 1280 x 800 Resolution with P-Cap Multi-touch Screen
- Low-Power System with Intel® Celeron® N2930 Processor
- Fanless Cooling System and Ultra-low Power Consumption
- Dual Gigabit Ethernet
- Room Booking Schedule, Access Control, Room Information Display
- Front IP65 Water and Dust Proof
- Red/Green/Blue/Orange LED Light Bar Indicators, on 2 sides
- Optional HF RFID
- Support PoE function



FRONT VIEW



SIDE VIEW

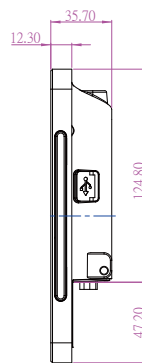

BOTTOM VIEW

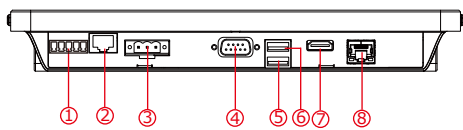

1. Digital I/O (Optional)
2. RJ-45 (PoE / LAN)
3. 12 DC-IN Terminal Block (Phoenix Type)
4. RS232/422/485
5. USB 2.0
6. USB 3.0
7. HDMI
8. RJ-45 (LAN)
9. Speaker

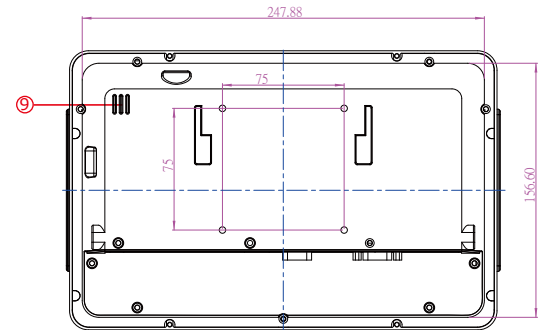

BACK VIEW

## Specifications

### System :

- Processor : Intel® Celeron® Bay Trail-M N2930 1.83GHz
- System Chipset : Intel® ATOM SoC Integrated
- System Memory : 2GB DDR3L 1066/1333 SODIMM
- Storage : 64GB mSATA SSD
- LAN : Dual Intel® WG82574L GbE LAN

### Input / Output

- Serial Ports : 1 x RS232/422/485
- USB Ports : 1 x USB 3.0, 1 x USB 2.0
- Ethernet : 2 x RJ 45-10/100/1000 Mbps
- HDMI : 1 x HDMI
- Speaker : 1 x 1 Watt Speaker

### Display Spec :

- Size/Type : 10.1" TFT (Wide screen)
- Resolutions : 1280x800
- Brightness : 300cd/m (typ.)
- Contrast Ratio : 800 : 1 (typ.)
- Viewing Angle : -89~89(H); -89~89(V)
- Max Colors : 262K(6bit)
- Touch : Projective-Capacitive Touch

### Power Specifications :

- Power Input : 12V DC IN Terminal Block (Phoenix Type)
- Power Over Ethernet : Support IEEE 802.3at (25W)

### Mechanical Specification :

- Cooling System : Fanless design
- Mounting : VESA Mount(75x75mm)
- Dimension (W x H x D) : 263.28 x 171 x 35.7 (mm)

### Environment Considerations :

- Operating Temperature : 0 deg.C to 50deg.C
- Operating Humidity : 30% to 90% (non condensing)

### Security Support :

- Trusted Platform Module (TPM 1.2)

### OS/BSP Driver Support :

- Operating System : Windows 10 IoT Enterprise  
: Windows Embedded 8.1 Industry Pro  
: Windows Embedded 8 Standard  
: Windows Embedded 7 Standard

### HF RFID (Optional) :

- Optional HF RFID 13.56MHz

### Software :

- Utility : "HotTab"-hotkeys Functions tool