

## Primelco **QuickConnect** Touchpanel PC **QCT-Series**

Primelco entwickelte eine Touchpanel-Serie optimiert für Anwendungen in der Gebäudeautomatisation. Ihre Vorteile:

- ▣ **Minimieren Sie Ihre Montagekosten:** Schnelle, kostengünstige Montage an einer Standard Gr-1 Wanddose
- ▣ **Schaffen Sie Sicherheit:** Keine sichtbaren Kabel oder zugängliche Schnittstellen! Verriegelbar: Dank QuickLock-Mechanismus vor Diebstahl geschützt.
- ▣ **Simplel:** Keine zusätzliche Wandhalterung oder Unterputzdose notwendig. Wandbündige Montage. Demontierbar ohne Instandstellungsarbeiten!
- ▣ **Erweitern Sie Ihr System:** In Grössen 7" und 10.1" mit Betriebssystem Linux, Windows10IoT und Android (FullyKiosk+) erhältlich!
- ▣ **Flexibel im Betrieb:** Ob per PoE, 230VA oder DC betrieben entscheiden Sie selbst dank wechselbaren Wandadapter
- ▣ **Ready-to-use:** Vorinstallierter und lizenzierter Kiosk-Browser (FullyKiosk+) bei Android Betriebssystem ermöglicht schnelle und sichere Inbetriebnahme und Remotemanagement
- ▣ **Design:** In der Schweiz entwickelt und produziert. Gehäuse aus vollem Aluminium, hochwertig und langlebig!
- ▣ **Service und Support** in und aus der Schweiz

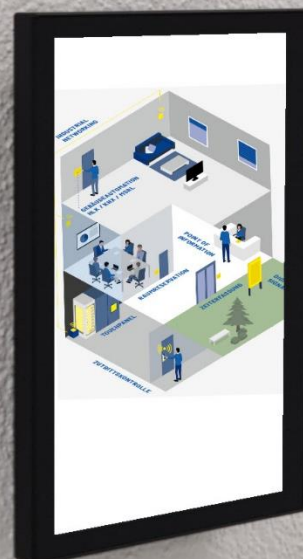

### Technical specification

		7,0"	10,1"
Housing	Material	Aluminum	
	Color	Black painted Trend9	
	Weight	Approx. 1.1 KG	Approx. 1.3 KG
	Dimensions (LxHxW)	115 x 182 x 36 mm	163 x 241 x 36 mm
	Mounting Options	Primelco Quick Connect Mounting system	
	IP Grade	Front IP54 / Back IP41 (wall mounted)	
Panel and Touch	Display ratio	16:9 LCD-TFT	16:10 LCD-TFT
	Resolution	1024x600	1280x800
	Brightness typ.	400 nits (cd/m2)	400 nits (cd/m2)
	Contrast Ratio	800:1	800:1
	Backlight	LED	LED
	Viewing angle.	85/85	89/89
	Touchscreen	Projected capacitive, Multi-touch	
	Surface hardness	Hard Coated	
	Structure surface	Matt, anti-glare	
	RFID (Option)	Standard	n/a
System	Processor	INTEL® E3930 dual-core (Optional E3940 quad-core, 8GB RAM,128GB eMMC)	
	Supports OS	Windows 10 IoT, Android 6.0 KIOSK Browser, Linux	
	System Memory	1x LDDR4 on board 4GB (8GB on request)	
	Storage	1x eMMC 64 GB (128GB on request)	
	Ethernet	1GbE (PoE option available)	
	Power Input	14 to 28VDC or PoE at (25W) depends on Quick Connect Adapter	
	Power Consumption	Approx. 12Watt, max. 15Watt	Approx. 15Watt, max. 20Watt
I/O Connectors	Serial Ports	Internal only	
	USB Ports	Internally only (1 additional USB on PoE Quick Connect Adapter)	
	LAN Port	1 x RJ45 on connecting board	
Environmental	Usability	Indoor 24/7	
	Operating Temperature	0 to 40°C	
	Storage Temperature	-5 to 60 °C	
	Operating Humidity	90% RH no dew condensation	
	IP Grade	Front IP54 / Back IP30 (wall mounted)	
	Certification	RoHS, CE (Conformity)	
Order Information (P/N)	We refer to price list PriControl-II		

### QCT with integrated RFID:

Integrated HF-RFID\* reader. Following standards are supported:  
LEGIC (ISO14443A / 15693), Mifare DESFire, NFC Forum Type 2/3, hitag

\*Reads UID by default (RFID-Modul can be programmed to read specific segments on customer request. Please contact sales to get a quote).



There are two Options to mount QCT-RFID:

- With QuickConnect Adapter
- With Standard I/O (USB/24VDC or PoE) as shown in picture



### How to (un-)lock Terminal:

Use 2.5mm INBUS on bottom side to lock Terminal to wall-mount adapter

Clockwise : unlock terminal

Counter-clockwise : lock terminal

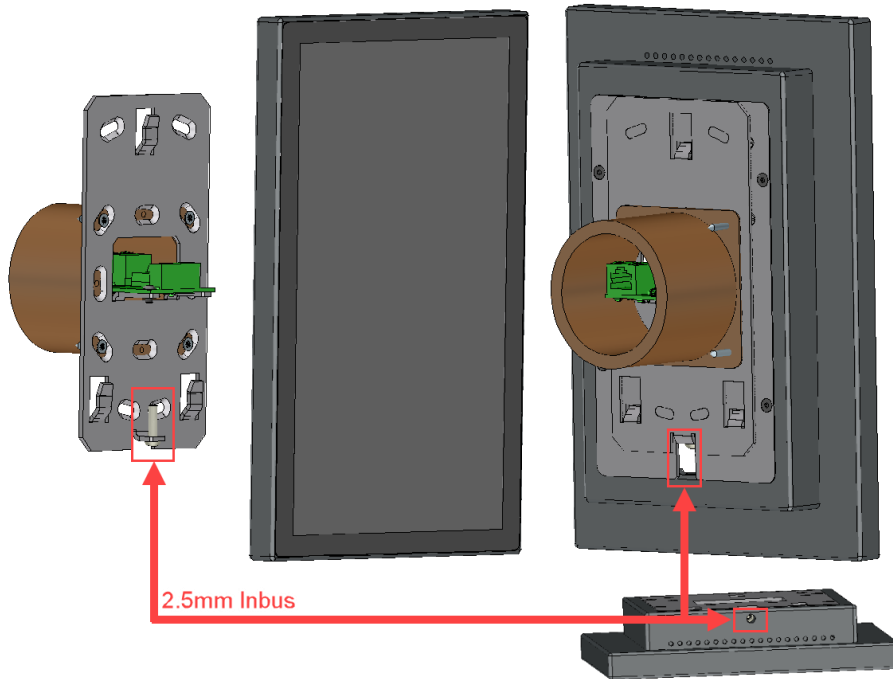

### Kiosk-Brower FullyKiosk+

Each QCT Android Version has pre-installed and licensed FullyKiosk+ Brower.  
Fully description of all features please check:

<https://www.fully-kiosk.com/de/>

#### Main features

- Show websites
- Lockdown or configure numerous web content features
- Handle PDF, Videos and other contents
- Universal Launcher
- Customizable Toolbars and Appearance
- Configurable browsing controls
- Auto reload website
- Configure your device
- Screensaver
- Kiosk Mode
- Website Integration
- Remote Admin
- Daily Usage Statistics
- Recover the app

#### Settings

Remote Administration (PLUS)	
Access Fully remotely from web browser in local network or worldwide	
Enable Remote Administration	Show info, configure and control Fully app remotely
Remote Admin Password	Password needed for remote admin site and for adding the device to Fully C
Remote Admin from Local Network	Enable remote admin and REST interface in the local network
Enable File Management on Remote Admin	Allow listing and downloading local files using remote admin This option can
Enable Screenshot on Remote Admin	Allow getting a screenshot on remote admin This option can't be changed fr
Enable Camshot on Remote Admin	Allow getting a camshot on remote admin (requires Motion Detection) This c Admin
Remote Admin from Fully Cloud	Manage the device in Fully Cloud

#### Settings

Kiosk Mode (PLUS)	
Lockdown device, prevent from accessing other apps, settings or buttons, set PIN, single app mode	
Enable Kiosk Mode	<input type="checkbox"/>
Lockdown device with exit gesture and PIN This option can't be changed from Remote Admin as kiosk mode changes require user input on the device	
Kiosk Exit Gesture	Select the gesture to show the PIN dialog
Swipe from Left or Long Press Back (in Fully) ✎	
Kiosk Mode PIN	***** ✎
PIN needed to exit the Kiosk Mode, default: 1234	
Wifi/Settings PIN	
Set a special PIN for wifi or settings access only	
Disable Status Bar	<input checked="" type="checkbox"/>
Lock status bar and system settings access	
Disable Volume Buttons	<input checked="" type="checkbox"/>
Lock volume level in Kiosk Mode	
Limit the Volume Level	✎
Limit the volume on all audio streams to this maximum in percent, empty for disable	
Disable Power Button	<input checked="" type="checkbox"/>
Lock the power button in Kiosk Mode	
Disable Home Button	<input checked="" type="checkbox"/>
Lock the home button and auto-run Fully in Kiosk Mode on boot	
Disable Other Apps	<input checked="" type="checkbox"/>
Block apps not intentionally started by Fully	
Advanced Kiosk Protection	<input checked="" type="checkbox"/>
Enable advanced protection against starting other apps	
App Whitelist	✎
Allow selected apps or activities to go to foreground, one package/component name per line, may use * wildcard	
App Blacklist	✎
Always block selected apps or activities, one package/component name per line, may use * wildcard	
Single App Mode	
Auto-run an app with full kiosk mode protection	
Disable Notifications	<input type="checkbox"/>
Block all notifications from other apps	

### Mechanical drawings:

